

Note: Part numbers and standards' values may change. Consult LECO for the latest information.

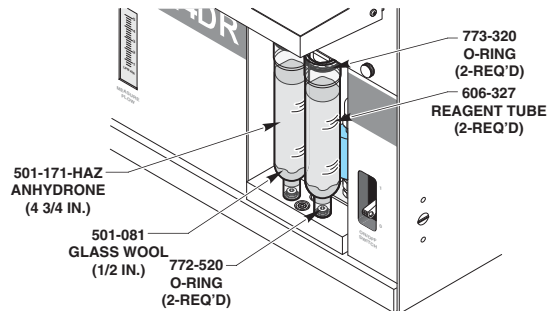

502-343 NICKEL BOAT LINER

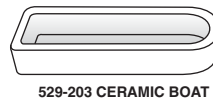
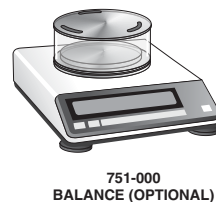
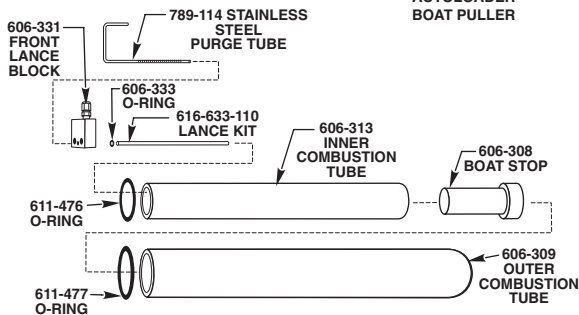
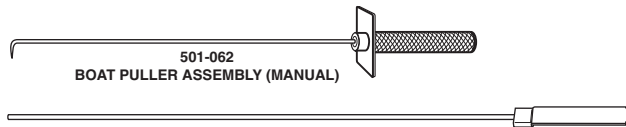
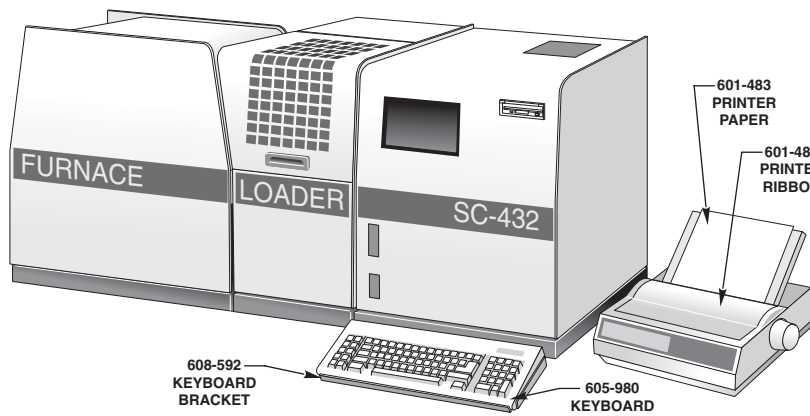
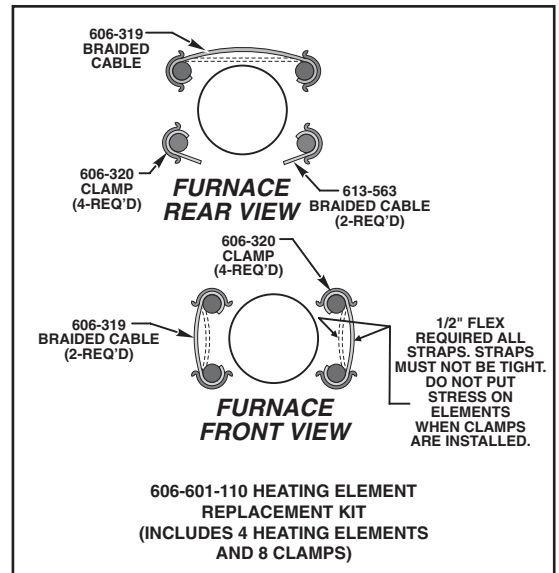

GENERAL COMBUSTION SUPPLIES

- 501-171-HAZ Anhydrene 454 g (1 lb. bottle)
- 769-608-HAZ Antimony Metal 200 g bottle (used for removal of fluorine and chlorine)
- 606-308 Boat Stop, Ceramic
- 501-426 ComAid™ for Solids 454 g (1 lb.) bottle
- 501-427 ComAid™ for Liquids 454 g (1 lb.) bottle
- 502-321 COM-CAT 250 g bottle
- 529-203 Combustion Boat - Ceramic 100/package
- 528-203-250 Combustion Boat - Ceramic 250/package
- 769-610 F-CL Absorbent Material 225 g bottle
- 501-081 Glass Wool 454 g (1 lb.) package
- 763-265 Glass Wool 277 g (0.5 lb.) package
- 502-351 Halogen Scrubber 50 g bottle
- 502-343 Nickel Boat Liner 100/package
- 789-114 Purge Tube (stainless steel), Drilled
- 502-301 Tungsten Trioxide Power 125 g bottle

COMBUSTION TUBES/GLASSWARE

- 606-313 Inner Combustion Tube, requires one (1) 611-476 O-ring, and one (1) 606-308 Boat Stop
- 616-633-110 Lance Tube Kit, includes 616-632 Lance Tube, 606-333 O-ring, 616-629 Lance Mounting Block
- 606-655 Large Volume Reagent Tube, requires one (1) 773-320 Top-O-ring, and one (1) 772-520 Bottom O-ring
- 606-309 Outer Combustion Tube, requires one (1) 611-477 O-ring
- 606-327 Reagent Tube, requires one (1) 773-320 Top O-ring, and one (1) 772-520 Bottom O-ring

See reverse side for contact information

OPERATION ACCESSORIES

606-352 Autoloader Boat Rack	502-023 Funnel
606-403 Adapter Brush	776-978 Glass Scoop, Large
619-591-699 Particle Filter	503-032 Glass Scoop, Regular
501-062 Boat Puller Assembly (Manual)	606-601 Heating Element (4)
606-547 Boat Pull (for Autoloader)	606-601-110 Heating Element Kit
613-563 Braided Cables (Short Strap)	606-316 Outlet Port Adapter, requires 773-320 O-ring
606-319 Braided Cable	601-483-100 Printer Paper
606-320 Clamps	601-484 Printer Ribbon
761-929 Crucible Tongs	501-241 Vacuum Grease
175-590 Diaphragm & Flapper Valve Kit (for Pump)	501-614 Spatula
613-564 Expansion Tool for T-Clamps	606-224 Thermocouple
	789-432-HAZ 5K Consum Pkg.

REFERENCE MATERIALS

COAL (50 grams)

Part No.	% Sulfur*
502-670	~0.5
502-671	~1.0
502-672	~2.0
502-673	~3.0
502-674	~4.5

SET-UP STANDARDS

PARAFFIN OIL (4 oz./118 ml)

Part No.	% Sulfur
502-421	0.90–1.10
502-422	1.90–2.10
502-423	3.90–4.10

ZINC SULFIDE (50 grams)

Part No.	% Sulfur
502-085	32.91

SOIL (65 grams)

Part No.	% C	% H	% N	% S
502-062	0.75–1.25	**	**	**
502-308	2.50–3.50	—	**	**
502-309	10.0–14.0	—	**	**

TOBACCO LEAVES (20 grams)

Part No.	% C	% H	% N	% S
502-082	35.0–47.0	4.0–7.0	2.0–4.0	0.3–0.8

EDTA (50 grams)

Part No.	% C	% H	% N	% S
502-092	40.80–41.20	5.46–5.54	9.52–9.60	—

EDTA (250 grams)

Part No.	% C	% H	% N	% S
502-092-250	40.80–41.20	5.46–5.54	9.52–9.60	—

GLYCINE (50 grams)

Part No.	% C	% H	% N	% S
502-211	32.00	6.67	18.66	—

CORN GLUTEN (50 grams)

Part No.	% C	% H	% N	% S
502-272	51.0–53.0	7.0–7.5	11.0–12.0	0.75–1.0

SET-UP STANDARDS (continued)

ALFALFA (50 grams)

Part No.	% C	% H	% N	% S
502-273	45.0–47.0	5.5–6.5	2.5–5.0	0.25–0.35

WHEAT FLOUR (50 grams)

Part No.	% C	% H	% N	% S
502-274	44.0–46.0	6.0–7.0	2.5–3.5	0.15–0.25

RYE FLOUR (50 grams)

Part No.	% C	% H	% N	% S
502-275	43.5–45.5	6.0–7.0	1.5–2.5	0.10–0.20

OAT MEAL (50 grams)

Part No.	% C	% H	% N	% S
502-276	45.0–47.0	6.0–7.0	2.5–3.5	0.15–0.25

BARLEY (50 grams)

Part No.	% C	% H	% N	% S
502-277	45.0–47.0	6.0–7.0	1.0–3.0	0.10–0.20

RICE FLOUR (50 grams)

Part No.	% C	% H	% N	% S
502-278	43.0–45.0	6.0–7.0	1.0–3.0	0.10–0.20

CERTIFIED REFERENCE MATERIALS

COAL (50 grams)

Part No.	%S*	Part No.	%S*
502-383	0.25	502-386	1.5
502-384	0.75	502-387	3.0
502-385	1.0	502-388	5.0

RESIDUAL FUEL OIL (4 oz./118 ml)

Part No.	%S	Part No.	%S
502-389	0.1	502-392	2.0
502-390	0.5	502-393	3.0
502-391	1.0	502-394	4.5

WHITE MINERAL OIL (4 oz./118 ml)

Part No.	% S	Part No.	%S
502-417	0.01	502-421	1.0
502-418	0.05	502-422	2.0
502-419	0.10	502-423	3.0
502-420	0.50		

DIESEL FUEL (4 oz./118 ml)

Part No.	% S	Part No.	%S
502-424	0.01	502-429	1.0
502-425	0.03	502-430	2.0
502-426	0.05	502-431	3.0
502-427	0.10	502-432	4.5
502-428	0.50		

*Reported on Dry Basis

**Values vary—contact LECO for current levels.

NOTES: Plant tissue samples should be dried at 85°C for two hours; all other samples should be dried at 105°C for one hour.

Part numbers and standards' values may change. Consult LECO for latest information.

United States:
Ph: 1-800-292-6141
Fax: 269-982-8977
Canada:
Ph: 1-800-268-0215
Fax: 905-564-6582

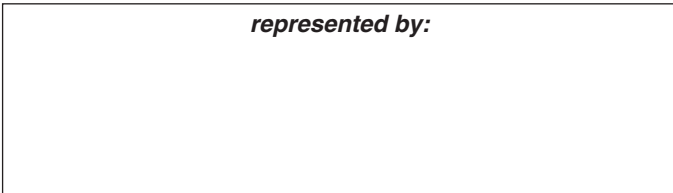

represented by:

Other Countries:
Ph: 269-983-5531
Fax: 269-983-3850

© 2011 LECO Corporation